

1220 HANEY PLAZA

Constructed in 1918, this 2,000 sq. ft. brick building is located within the Historic District near the original, gated entrance of Fort McPherson. It originally served as the post fire station and was later used as a post office and a print shop.

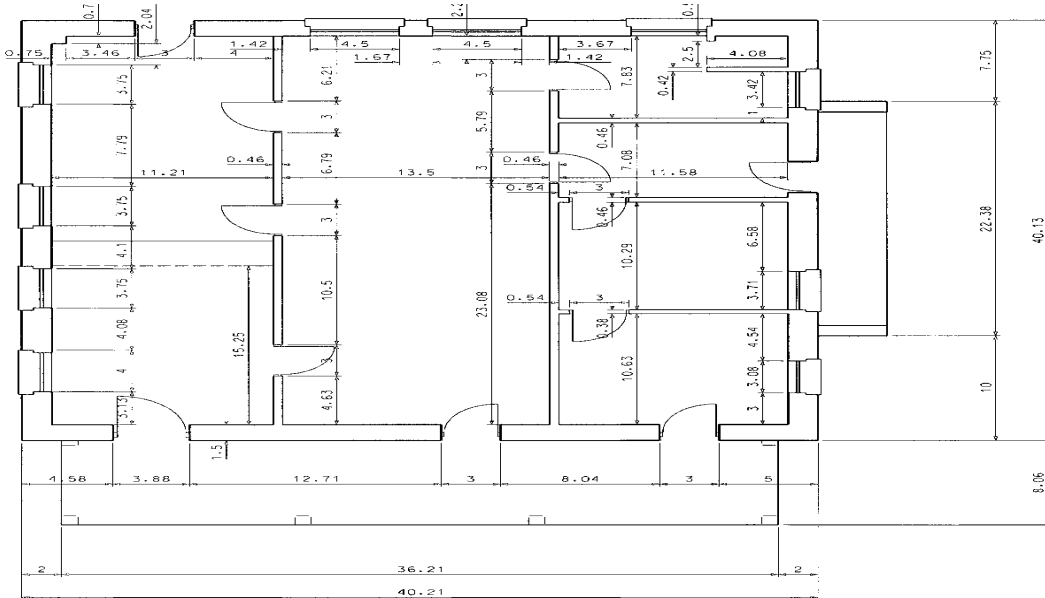

This historic property has covenants that binds the owner to maintain, preserve and enhance the architectural features that qualifies it for the National Register of Historic Places in perpetuity. The interior plan shown here has been modified to provide for two open rectangular spaces.

Disclaimer: McPherson Implementing Local Redevelopment Authority (Fort Mac LRA) does not guarantee the accuracy of any information describing the property. For additional information, contact MILRA at (404) 477-6767 or via email at info@fortmaclra.com.